



FOUNDATION PLUMBING PLAN - UNIT 2  
3/16" = 1'-0"

THIS DRAWING SHEET IS INTENDED TO BE PLOTTED IN COLOR. IF THIS TEXT APPEARS IN BLACK AND WHITE, IT IS PLOTTED INCORRECTLY. DISCARD AND OBTAIN AN ACCURATE DRAWING

TowerPinkster  
Architecture - Engineering - Interiors

Risepointe  
architecture • design • interiors  
1520 N. WENDS STREET  
SEATTLE, WA 98103  
206.447.4455



TOWNE SOUTH CHURCH  
2224 PEARTREE RD.  
ELIZABETH CITY, NC 27909

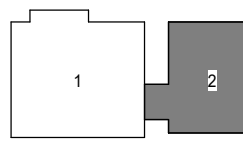

KEY PLAN

ARCHITECTURE  
RISEPORTE  
CONTACT: CHRIS STRASSER  
200 N. HARRISON ST. UNIT 101  
ALCONGAN, IL 60102  
P 630.800.887  
WWW.RISEPORTE.COM

GENERAL CONTRACTOR  
A.R. CHESSON  
CONTACT: CHRIS MORRIS  
136 E. RICH BLVD.  
ELIZABETH CITY, NC 27909  
P 252.338.8171  
WWW.ARCHESON.COM

CIVIL ENGINEERING  
EASTERN CAROLINA CONSTRUCTION  
CONTACT: BRIANT ROBERTY  
154 US HWY 101 E.  
CAMDEN, NC 27801  
P 252.621.3575  
WWW.EASTERNCAROLINAENGINEERING.COM

STRUCTURAL  
TOWER PINKSTER  
CONTACT: BAILEY RAHLER  
4 FULTON ST. E. #200  
GRAND RAPIDS, MI 49503  
P 616.794.6225  
WWW.TOWERPINKSTER.COM

MECHANICAL  
TOWER PINKSTER  
CONTACT: DENVER WESSELS  
4 FULTON ST. E. #200  
GRAND RAPIDS, MI 49503  
P 616.455.9944  
WWW.TOWERPINKSTER.COM

ELECTRICAL  
TOWER PINKSTER  
CONTACT: CYNTHIA NICOLESON  
4 FULTON ST. E. #200  
GRAND RAPIDS, MI 49503  
P 616.455.9944  
WWW.TOWERPINKSTER.COM

PLUMBING  
TOWER PINKSTER  
CONTACT: DENVER WESSELS  
4 FULTON ST. E. #200  
GRAND RAPIDS, MI 49503  
P 616.455.9944  
WWW.TOWERPINKSTER.COM

AUDIO - VIDEO - LIGHTING - ACOUSTICS  
LIVESPACE  
CONTACT: JONAH HENRY  
4860 STARR ST. SE  
GRAND RAPIDS, MI 49504  
P 616.572.8547  
WWW.LIVESPACE.COM

INTERIOR TECHNOLOGY  
INTULISE  
CONTACT: CHRIS STEB  
151 FORDSHIRE DR.  
LANCASTER, PA 17601  
P 717.795.5382  
WWW.INTULISE.COM

PROJECT NAME  
TOWNE SOUTH CHURCH  
2224 PEARTREE RD.  
ELIZABETH CITY, NC 27909

CURRENT ISSUE  
ISSUED FOR RFP CD  
2026.04.30

SHEET NAME  
FOUNDATION PLUMBING  
PLAN - UNIT 2

PROJECT NUMBER  
25-623

SCALE  
3/16" = 1'-0"

DRAWING NUMBER  
P-002

10/26/2025 14:52:24 PM  
COPYRIGHT 2025 RISEPORTE ALL RIGHTS RESERVED  
USE BY: JEFFREY N. PARSONS ONLY